

Grade 10 Chain Slings

Chain Size mm	Grade	Single Leg	Choke Hitch	Endless	Two Leg		Three and Four Leg	
					0°-45°	45°-60°	0°-45°	45°-60°
6	10	1.4	1.12	2.2	2.0	1.4	2.9	2.1
8	10	2.5	2.0	4.0	3.5	2.5	5.3	3.8
10	10	4.0	3.15	6.4	5.6	4.0	8.4	6.0
13	10	6.7	5.3	10.6	9.5	6.7	14.0	10.0
16	10	10.0	8.0	16.0	14.0	10.0	21.0	15.0
20	10	16.0	12.8	25.6	22.4	16.0	33.6	24.0
22	10	19.0	15.0	30.4	26.5	19.0	40.0	28.0
26	10	26.5	21.2	42.4	37.1	26.5	55.7	39.8
32	10	40.0	32.0	65.0	56.0	40.0	85.0	60.0

All loads shown in tonnes

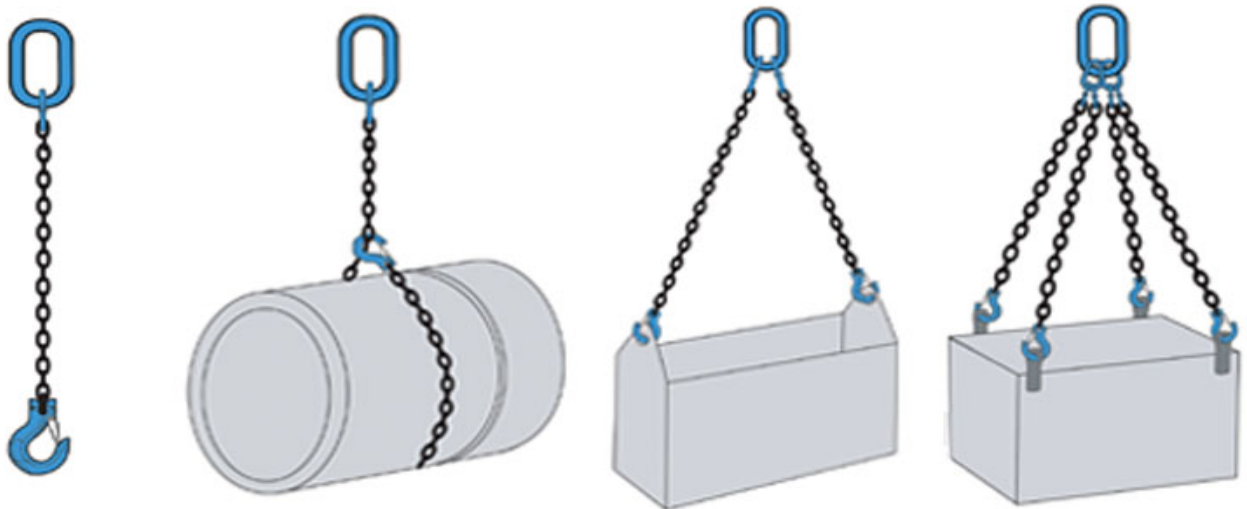

Grade 10 Short Link Chain

Mechanical properties in accordance with EN818-2 +25% and ASTM A973/A973M.

Chemical composition and dimensions conform to EN818-2.

The Grade 10 chain is embossed with manufacturer's mark and grade (MA10) and class leading batch code traceability.

All sizes for the William Hackett Grade 10 are proof tested at manufacture to 2.5 times the given working load limit and have a range of diameters from 6mm – 32mm. The Hackett Grade 10 chain is suitable for use in a temperature range of -40°C up to 200°C without reduction in working load limit.

Surface Finish: Blue Painted.

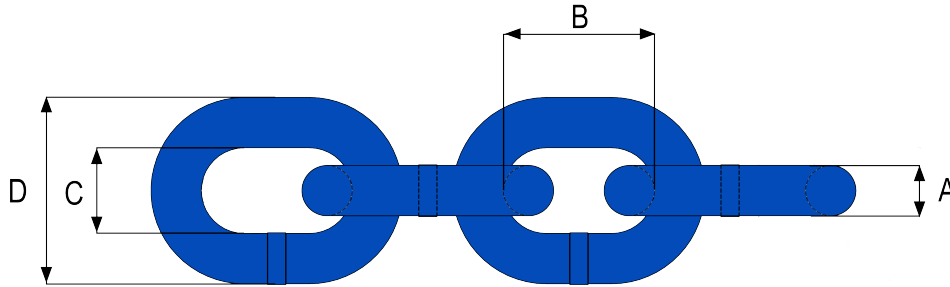

METRIC SPECIFICATIONS

Part Code	Chain Size A mm (Nominal)	B mm (Nominal)	C mm (Minimum)	D mm (Maximum)	WLL tonnes	kgs per metre	Metres per drum
ASV.060.5	6	18	9.1	25.9	1.4	0.80	500
ASV.080.5	8	24	10.4	29.6	2.5	1.51	350
ASV.100.5	10	30	13.0	37.0	4.0	2.35	250
ASV.130.5	13	39	16.9	48.1	6.7	3.99	150
ASV.160.5	16	48	20.8	59.2	10.0	5.99	100
ASV.200.5	20	60	26.0	74.0	16.0	9.76	60
ASV.220.5	22	66	28.6	81.4	19.0	11.70	50
ASV.260.5	26	78	33.8	96.2	26.5	16.12	30
ASV.320.5	32	96	41.6	118.0	40.0	24.80	25

IMPERIAL SPECIFICATIONS

Part Code	Chain Size A inch (Nominal)	B inch (Nominal)	C inch (Minimum)	D inch (Maximum)	WLL lbs	lbs per ft	feet per drum
ASV.060.5	7/32	0.70	0.35	1.02	3000	0.54	1640
ASV.080.5	5/16	0.90	0.40	1.17	5700	1.00	1148
ASV.100.5	3/8	1.18	0.51	1.46	8800	1.58	820
ASV.130.5	1/2	1.54	0.66	1.90	15000	2.68	492
ASV.160.5	5/8	1.89	0.82	2.33	22600	4.02	328
ASV.200.5	3/4	2.36	1.02	2.91	35300	6.56	196
ASV.220.5	7/8	2.59	1.12	3.20	42700	7.86	164
ASV.260.5	1	3.07	1.33	3.79	59600	10.83	98
ASV.320.5	1-1/4	3.78	1.63	4.65	90400	16.66	82

Hack10 Component Connector

All William Hackett Hack10 lifting components comply fully with the relevant section of EN1677, ASTM A952/A and DIN PAS 1061. The grade 10 components are forged from alloy steel, they are crack detected following heat treatment and finally proof tested to 2.5 times working load. The full compliance of these components means that they can be used in chain slings certified to EN 818-4, for use in a temperature range of -40°C up to 200°C without reduction in working load limit.

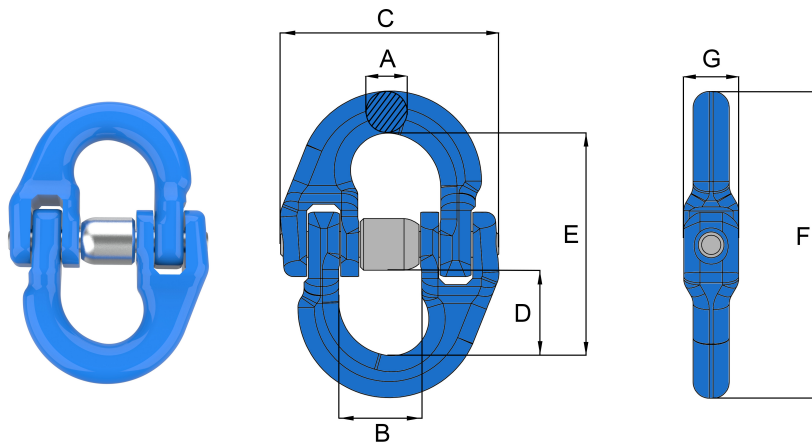

METRIC SPECIFICATIONS

Part Code	Chain Size mm	A mm	B mm	C mm	D mm	E mm	F mm	G mm	WLL tonnes	Box Quantity	Mass kg
10-H03-06	6	7.0	14.0	40.0	16.0	44.5	62.0	12.0	1.4	200	0.11
10-H03-08	8	10.0	18.5	53.0	24.0	63.0	84.0	14.0	2.5	150	0.18
10-H03-10	10	12.6	23.0	64.0	28.0	71.0	97.0	18.0	4.0	50	0.34
10-H03-13	13	16.5	28.0	81.0	34.0	92.5	126.0	23.0	6.7	35	0.68
10-H03-16	16	20.0	33.5	103.0	39.0	106.5	145.0	30.0	10.0	20	1.22
10-H03-20	20	25.0	42.0	119.5	44.0	123.0	175.0	35.0	16.00	10	2.13
10-H03-22	22	27.0	48.0	142.0	50.0	137.5	193.0	39.0	19.00	6	3.00
10-H03-26	26	32.0	61.0	169.0	63.0	161.0	229.0	46.0	26.50	3	5.20
10-H03-32	32	40.0	80.0	218.0	78.0	197.0	279.0	54.0	40.00	2	9.55

IMPERIAL SPECIFICATIONS

Part Code	Chain Size inch	A inch	B inch	C inch	D inch	E inch	F inch	G inch	WLL lbs	Box Quantity	Mass lbs
10-H03-06	7/32	0.27	0.55	1.57	0.63	1.75	2.44	0.47	3086	200	0.24
10-H03-08	5/16	0.39	0.73	2.08	0.94	2.48	3.31	0.55	5511	150	0.39
10-H03-10	3/8	0.49	0.90	2.52	1.10	2.80	3.82	0.71	8818	50	0.74
10-H03-13	1/2	0.65	1.10	3.19	1.34	3.64	4.96	0.91	14771	35	1.49
10-H03-16	5/8	0.78	1.32	4.05	1.54	4.19	5.71	1.18	22046	20	2.68
10-H03-20	3/4	0.98	1.65	4.70	1.73	4.84	6.89	1.38	35274	10	4.69
10-H03-22	7/8	1.06	1.89	5.59	1.97	5.41	7.60	1.54	41887	6	6.61
10-H03-26	1	1.26	2.40	6.65	2.48	6.34	9.01	1.81	58422	3	11.46
10-H03-32	1-17/64	1.57	3.15	8.58	3.07	7.76	10.98	2.13	88184	2	21.05

Hack10 Clevis Sling Hook

All William Hackett Hack10 lifting components comply fully with the relevant section of EN1677, ASTM A952/A and DIN PAS 1061. The grade 10 components are forged from alloy steel, they are crack detected following heat treatment and finally proof tested to 2.5 times working load. The full compliance of these components means that they can be used in chain slings certified to EN 818-4, for use in a temperature range of -40°C up to 200°C without reduction in working load limit.

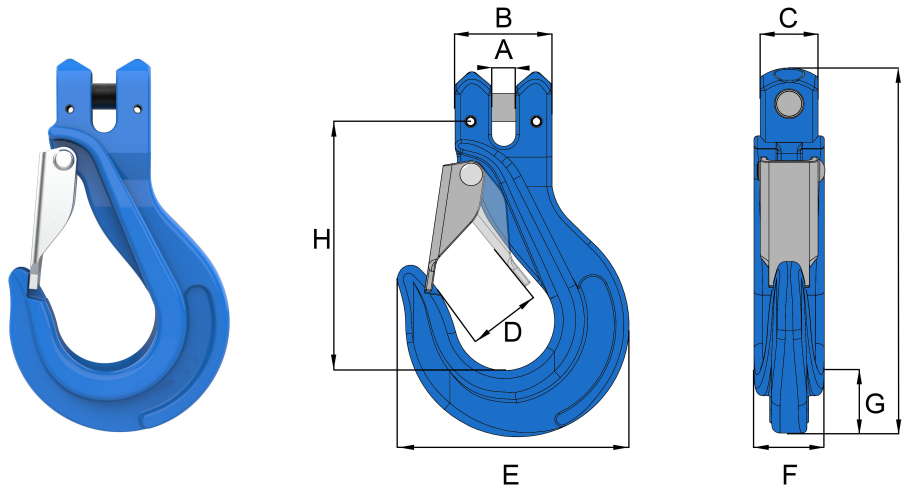

METRIC SPECIFICATIONS

Part Code	Chain Size mm	A mm	B mm	C mm	D mm	E mm	F mm	G mm	H mm	I mm	WLL tonnes	Box Quantity	Mass kg
10-H04-06	6	8.0	32.0	18.0	23.0	66.0	15.5	19.0	79.0	112.0	1.4	40	0.30
10-H04-08	8	9.0	35.0	23.0	27.0	85.0	20.0	25.0	99.3	140.0	2.5	30	0.60
10-H04-10	10	12.0	44.0	25.5	33.0	103.0	24.0	35.0	121.0	174.0	4	15	1.19
10-H04-13	13	15.0	57.0	34.0	40.0	133.0	38.0	38.0	147.6	213.6	6.7	8	2.32
10-H04-16	16	18.5	70.0	41.5	44.0	157.0	41.5	41.0	166.0	250.0	10	6	3.82
10-H04-20	20	23.0	85.0	51.0	53.0	192.0	48.0	50.0	200.0	292.0	16	3	6.77
10-H04-22	22	25.0	97.5	61.0	72.0	240.0	57.0	64.0	228.0	339.0	19	2	10.0

IMPERIAL SPECIFICATIONS

Part Code	Chain Size inch	A inch	B inch	C inch	D inch	E inch	F inch	G inch	H inch	I inch	WLL lbs	Box Quantity	Mass lbs
10-H04-06	7/32	0.31	1.12	0.71	0.91	2.60	0.61	0.75	3.11	4.41	3086	40	0.66
10-H04-08	5/16	0.35	1.38	0.90	1.06	3.35	0.78	0.98	3.91	5.51	5511	30	1.32
10-H04-10	3/8	0.47	1.73	1.00	1.30	4.05	0.94	1.10	4.76	6.85	8818	15	2.62
10-H04-13	1/2	0.59	2.24	1.34	1.57	5.24	1.49	1.49	5.81	8.41	14771	8	5.11
10-H04-16	5/8	0.73	2.64	1.63	1.73	6.34	1.63	1.61	6.53	9.65	22046	6	8.42
10-H04-20	3/4	0.90	3.15	2.00	2.09	7.36	1.89	1.97	7.87	11.50	35274	3	14.92
10-H04-22	7/8	0.98	3.84	2.40	2.83	9.45	2.24	2.48	8.97	13.35	41887	2	22.04

Hack10 Clevis Self Locking Hook

All William Hackett Hack10 lifting components comply fully with the relevant section of EN1677, ASTM A952/A and DIN PAS 1061. The grade 10 components are forged from alloy steel, they are crack detected following heat treatment and finally proof tested to 2.5 times working load. The full compliance of these components means that they can be used in chain slings certified to EN 818-4, for use in a temperature range of -40°C up to 200°C without reduction in working load limit.

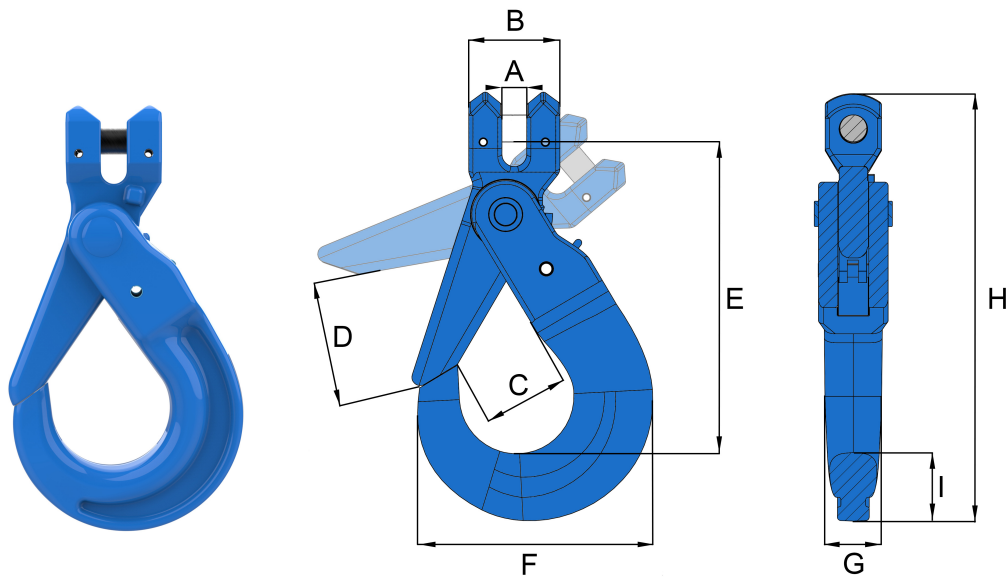

METRIC SPECIFICATIONS

Part Code	Chain Size mm	A mm	B mm	C mm	D mm	E mm	F mm	G mm	H mm	I mm	WLL tonnes	Box Quantity	Mass kg
10-H05-06	6	8.0	32.0	28.0	31.5	96.0	73.0	15.0	131.0	21.0	1.4	40	0.5
10-H05-08	8	9.5	36.0	36.0	40.0	121.0	90.0	20.0	163.0	27.0	2.5	20	0.9
10-H05-10	10	12.0	46.0	45.0	46.0	144.0	108.0	26.0	194.0	30.0	4.0	15	1.6
10-H05-13	13	15.0	59.0	53.6	66.0	182.0	137.0	32.5	251.0	41.0	6.7	6	2.9
10-H05-16	16	18.5	70.0	61.0	75.0	220.0	168.0	38.0	303.0	51.0	10.0	4	5.0
10-H05-20	20	25.0	85.0	76.5	80.0	235.0	190.0	50.0	337.0	64.0	16.0	2	8.6
10-H05-22	22	25.5	98.0	76.0	104.6	271.0	202.0	52.0	386.0	67.0	19.0	2	12.1

IMPERIAL SPECIFICATIONS

Part Code	Chain Size inch	A inch	B inch	C inch	D inch	E inch	F inch	G inch	H inch	I inch	WLL lbs	Box Quantity	Mass lbs
10-H05-06	7/32	0.31	1.26	1.10	1.24	3.78	2.87	0.59	5.16	0.83	3086	40	1.10
10-H05-08	5/16	0.37	1.42	1.42	1.57	4.76	3.54	0.79	6.42	1.06	5511	20	1.98
10-H05-10	3/8	0.47	1.81	1.77	1.81	5.67	4.25	1.02	7.64	1.18	8818	15	3.52
10-H05-13	1/2	0.59	2.32	2.11	2.60	7.16	5.39	1.28	9.88	1.61	14771	6	6.39
10-H05-16	5/8	0.73	2.75	2.40	2.95	8.66	6.61	1.50	11.93	2.01	22046	4	11.02
10-H05-20	3/4	0.98	3.35	3.01	3.15	9.25	7.48	1.97	13.27	2.52	35274	2	18.95
10-H05-22	7/8	1.00	3.86	2.99	4.12	10.67	7.95	2.05	15.19	2.64	41887	2	26.67

Hack10 Clevis Grab Hook

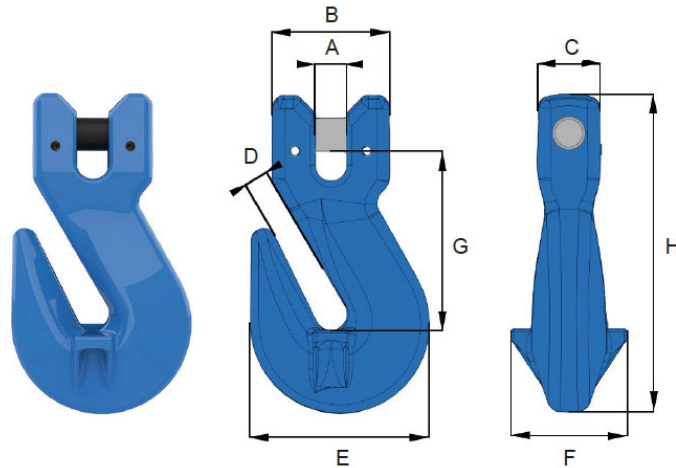

Metric Specifications

Part Code	Chain Size mm	A mm	B mm	C mm	D mm	E mm	F mm	G mm	H mm	WLL t	Box Qty.	Mass kg
10-H19-08	8	9.5	36.0	24.0	11.0	54.0	33.5	53.0	93.0	2.5	70	0.34
10-H19-10	10	12.5	46.0	29.5	13.5	72.0	42.0	73.0	127.0	4.0	25	0.92
10-H19-13	13	15.0	59.0	37.0	15.0	96.0	53.5	92.0	164.0	6.7	15	1.98
10-H19-16	16	18.5	70.0	46.0	19.0	115.0	74.0	103.0	188.0	10.0	6	3.42

Imperial Specifications

Part Code	Chain Size inch	A inch	B inch	C inch	D inch	E inch	F inch	G inch	H mm	WLL lbs	Box Qty.	Mass lbs
10-H19-08	5/16	0.37	1.42	0.94	0.43	2.13	1.32	2.09	3.66	5700	70	0.75
10-H19-10	3/8	0.49	1.81	1.16	0.53	2.83	1.65	2.87	5.00	8800	25	2.03
10-H19-13	1/2	0.59	2.32	1.46	0.59	3.78	2.11	3.62	6.46	15000	15	4.36
10-H19-16	5/8	0.73	2.76	1.81	0.75	4.53	2.91	4.06	7.40	22600	6	7.54

Hack10 Eye Grab Hook

All William Hackett Hack10 lifting components comply fully with the relevant section of EN1677, ASTM A952/A and DIN PAS 1061. The grade 10 components are forged from alloy steel, they are crack detected following heat treatment and finally proof tested to 2.5 times working load. The full compliance of these components means that they can be used in chain slings certified to EN 818-4, for use in a temperature range of -40°C up to 200°C without reduction in working load limit.

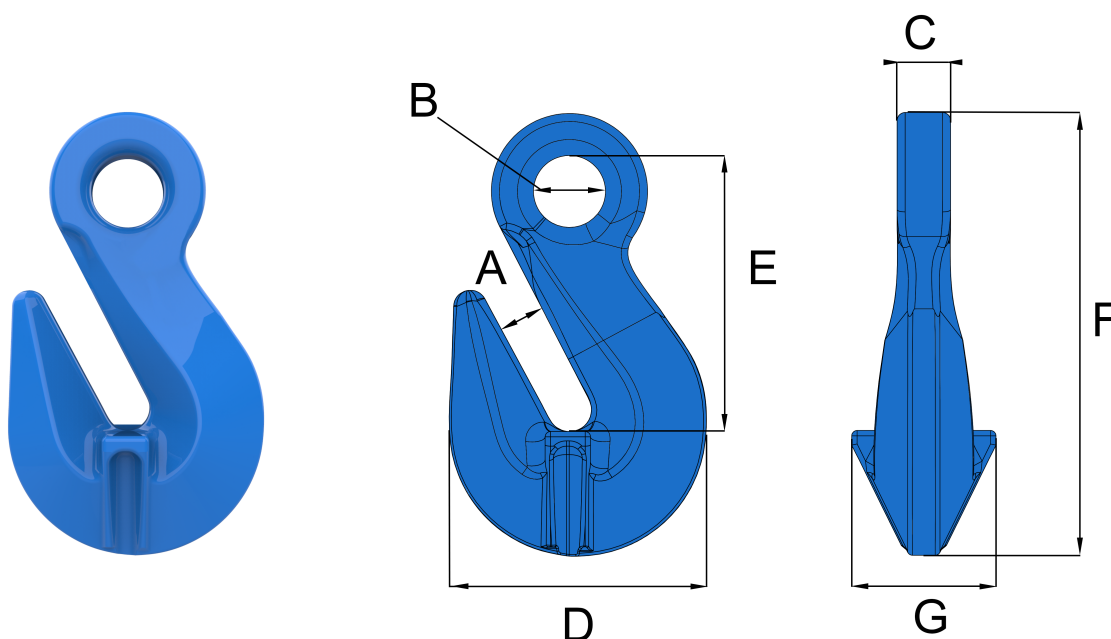

METRIC SPECIFICATIONS

Part Code	Chain Size mm	A mm	B mm	C mm	D mm	E mm	F mm	G mm	WLL tonnes	Box Quantity	Mass kg
10-H06-06	6	8.0	13.5	8.0	46.5	46.0	73.0	25.5	1.4	100	0.15
10-H06-08	8	11.0	17.5	9.5	53.0	61.0	93.0	33.5	2.5	80	0.30
10-H06-10	10	13.5	22.0	14.0	74.0	85.0	129.0	42.0	4.0	40	0.79
10-H06-13	13	17.0	27.0	18.5	96.0	104.0	166.0	53.5	6.7	12	1.67
10-H06-16	16	19.0	36.0	22.0	116.0	119.0	186.0	74.0	10.0	10	2.74
10-H06-20	20	25.0	44.0	23.0	145.0	146.0	225.0	87.0	16.0	6	4.72
10-H06-22	22	27.0	48.5	26.0	160.5	165.5	260.5	90.0	19.0	5	8.20
10-H06-26	26	34.0	52.0	34.0	190.0	204.0	311.0	110.0	26.5	2	11.35
10-H06-32	32	41.0	64.0	40.0	229.0	246.0	373.0	130.0	40.0	1	20.65

IMPERIAL SPECIFICATIONS

Part Code	Chain Size inch	A inch	B inch	C inch	D inch	E inch	F inch	G inch	WLL lbs	Box Quantity	Mass lbs
10-H06-06	7/32	0.31	0.53	0.31	1.83	1.81	2.87	1.00	3086	100	0.33
10-H06-08	5/16	0.43	0.69	0.37	2.08	2.40	3.66	1.32	5511	80	0.66
10-H06-10	3/8	0.53	0.86	0.55	2.91	3.35	5.08	1.65	8818	40	1.74
10-H06-13	1/2	0.67	1.06	0.73	3.78	4.09	6.53	2.10	14771	12	3.68
10-H06-16	5/8	0.75	1.42	0.87	4.57	4.68	7.32	2.91	22046	10	6.04
10-H06-20	3/4	0.98	1.73	0.90	5.70	5.75	8.86	3.42	35274	6	10.40
10-H06-22	7/8	1.06	1.91	1.02	6.32	6.51	10.25	3.54	41887	5	18.07
10-H06-26	1	1.34	2.05	1.34	7.48	8.03	12.24	4.33	58422	2	25.02
10-H06-32	1-17/64	1.61	2.52	1.57	9.01	9.68	14.68	5.12	88184	1	45.52

Hack10 Reeveable Link

All William Hackett Hack10 lifting components comply fully with the relevant section of EN1677, ASTM A952/A and DIN PAS 1061. The grade 10 components are forged from alloy steel, they are crack detected following heat treatment and finally proof tested to 2.5 times working load. The full compliance of these components means that they can be used in chain slings certified to EN 818-4, for use in a temperature range of -40°C up to 200°C without reduction in working load limit.

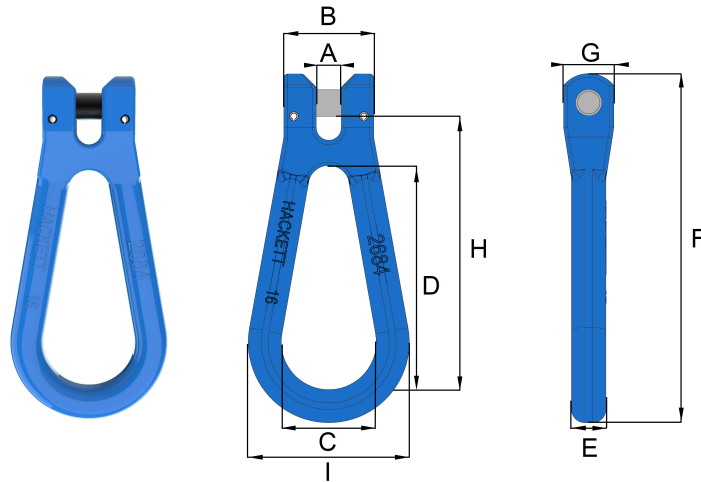

METRIC SPECIFICATIONS

Part Code	Chain Size mm	A mm	B mm	C mm	D mm	E mm	F mm	G mm	H mm	WLL tonnes	Box Quantity	Mass kg
10-H07-08	8	10.0	35.5	45.0	87.0	15.0	139.0	23.0	111.0	2.5	40	0.53
10-H07-10	10	12.0	42.0	60.0	108.0	19.0	174.0	27.0	128.0	4.0	20	0.74
10-H07-13	13	16.5	58.0	66.5	137.5	22.0	228.0	33.0	177.0	6.7	10	1.76
10-H07-16	16	19.0	68.0	72.0	165.0	26.0	264.0	39.0	207.0	10.0	8	2.80

IMPERIAL SPECIFICATIONS

Part Code	Chain Size inch	A inch	B inch	C inch	D inch	E inch	F inch	G inch	H inch	WLL lbs	Box Quantity	Mass lbs
10-H07-08	5/16	0.39	1.40	1.77	3.42	0.59	5.47	0.91	4.37	5511	40	1.16
10-H07-10	3/8	0.47	1.65	2.36	4.25	0.75	6.85	1.06	5.04	8818	20	1.63
10-H07-13	1/2	0.65	2.28	2.62	5.41	0.87	8.98	1.30	6.97	14771	10	3.88
10-H07-16	5/8	0.75	2.68	2.83	6.49	1.02	10.39	1.54	8.15	22046	8	6.17

Hack10 Clevis Clutch

All William Hackett Hack10 lifting components comply fully with the relevant section of EN1677, ASTM A952/A and DIN PAS 1061. The grade 10 components are forged from alloy steel, they are crack detected following heat treatment and finally proof tested to 2.5 times working load. The full compliance of these components means that they can be used in chain slings certified to EN 818-4, for use in a temperature range of -40°C up to 200°C without reduction in working load limit.

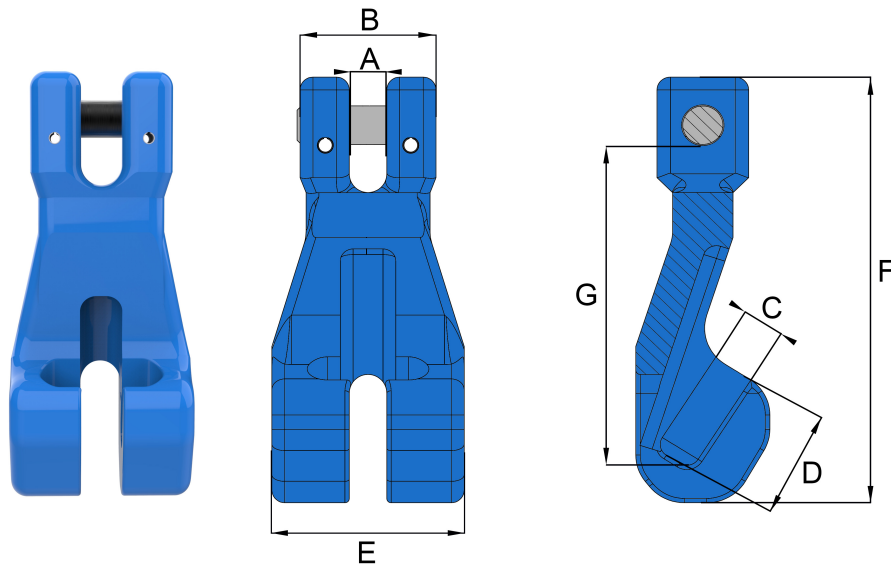

METRIC SPECIFICATIONS

Part Code	Chain Size mm	A mm	B mm	C mm	D mm	E mm	F mm	G mm	WLL tonnes	Box Quantity	Mass kg
10-H10-08	8	9.5	36.0	10.5	17.0	45.0	101.0	70.0	2.5	50	0.37
10-H10-10	10	13.0	48.0	12.4	28.0	55.0	138.0	101.5	4.0	21	0.97
10-H10-13	13	16.5	59.0	16.0	34.5	75.0	177.0	115.0	6.7	10	2.01
10-H10-16	16	18.5	70.0	19.5	40.0	93.0	220.0	150.5	10.0	6	3.32

IMPERIAL SPECIFICATIONS

Part Code	Chain Size inch	A inch	B inch	C inch	D inch	E inch	F inch	G inch	WLL lbs	Box Quantity	Mass lbs
10-H10-08	5/16	0.37	1.42	0.41	0.67	1.77	3.97	2.75	5511	50	0.81
10-H10-10	3/8	0.51	1.89	0.49	1.10	2.17	5.43	3.99	8818	21	2.13
10-H10-13	1/2	0.65	2.32	0.63	1.36	2.95	6.97	4.53	14771	10	4.43
10-H10-16	5/8	0.73	2.75	0.77	1.57	3.66	8.66	5.93	22046	6	7.31

Hack10 Clevis Shackle

All William Hackett Hack10 lifting components comply fully with the relevant section of EN1677, ASTM A952/A and DIN PAS 1061. The grade 10 components are forged from alloy steel, they are crack detected following heat treatment and finally proof tested to 2.5 times working load. The full compliance of these components means that they can be used in chain slings certified to EN 818-4, for use in a temperature range of -40°C up to 200°C without reduction in working load limit.

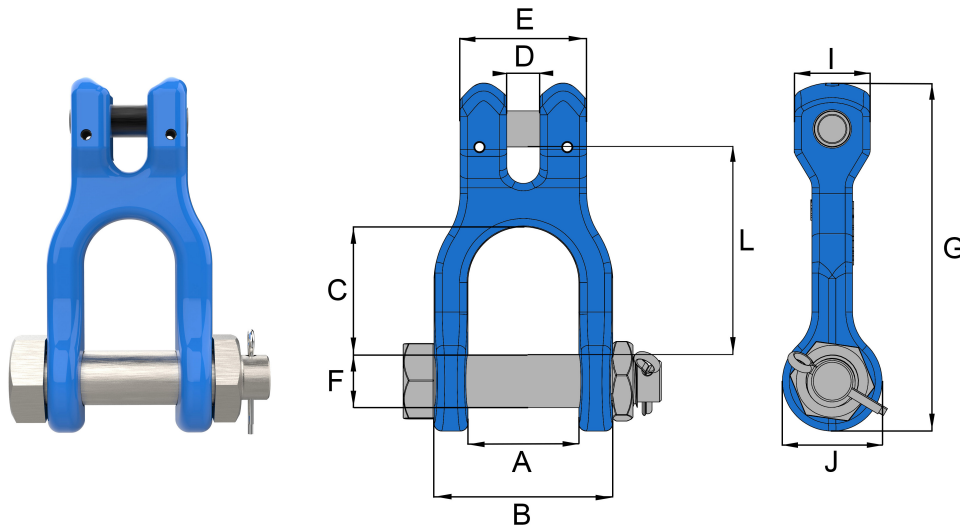

METRIC SPECIFICATIONS

Part Code	Chain Size mm	A mm	B mm	C mm	D mm	E mm	F mm	G mm	I mm	J mm	L mm	WLL tonnes	Box Quantity	Mass kg
10-H12-08	8	31.0	51.0	36.3	9.0	36.0	16.0	103.5	20.0	34.0	61.0	2.5	35	0.40
10-H12-10	10	34.0	62.0	48.0	12.5	46.5	20.0	130.7	25.0	40.0	78.5	4.0	20	0.89
10-H12-13	13	49.0	83.0	64.0	15.0	59.0	22.0	160.0	31.0	44.0	98.5	6.7	18	1.51
10-H12-16	16	58.0	95.0	69.5	19.0	70.0	28.5	190.5	40.0	55.0	114.0	10.0	10	2.62

IMPERIAL SPECIFICATIONS

Part Code	Chain Size inch	A inch	B inch	C inch	D inch	E inch	F inch	G inch	I inch	J inch	L inch	WLL lbs	Box Quantity	Mass lbs
10-H12-08	5/16	1.22	2.01	1.43	0.35	1.42	0.63	4.07	0.79	1.34	2.40	5511	35	0.88
10-H12-10	3/8	1.34	2.44	1.89	0.49	1.83	0.79	5.15	0.98	1.57	3.09	8818	20	1.96
10-H12-13	1/2	1.93	3.27	2.52	0.59	2.32	0.87	6.30	1.22	1.73	3.88	14771	18	3.32
10-H12-16	5/8	2.28	3.74	2.74	0.75	2.75	1.12	7.50	1.57	2.17	4.49	22046	10	5.77

Hack10 Swivel Self Locking Hook

All William Hackett Hack10 lifting components comply fully with the relevant section of EN1677, ASTM A952/A and DIN PAS 1061. The grade 10 components are forged from alloy steel, they are crack detected following heat treatment and finally proof tested to 2.5 times working load. The full compliance of these components means that they can be used in chain slings certified to EN 818-4, for use in a temperature range of -40°C up to 200°C without reduction in working load limit.

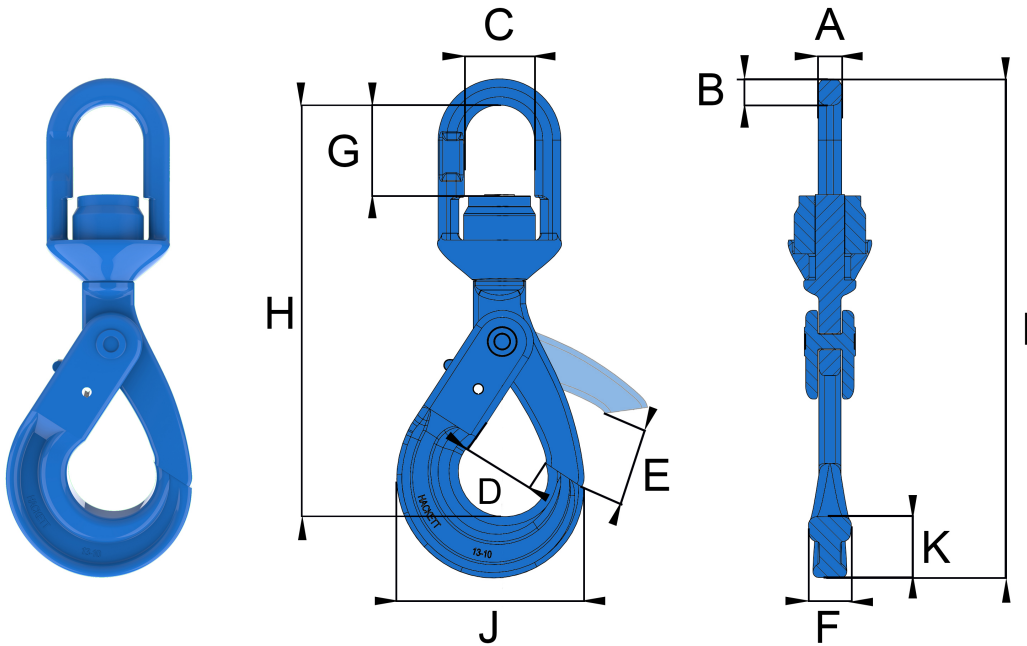

METRIC SPECIFICATIONS

Part Code	Chain Size mm	A mm	B mm	C mm	D mm	E mm	F mm	G mm	H mm	I mm	J mm	K mm	WLL tonnes	Box Quantity	Mass kg
10-H14-08	8	13.0	15.0	41	35.0	38.0	21.5	40.0	203	244	90	26.0	2.50	12	1.21
10-H14-10	10	15.5	17.5	48	45.0	48.0	22.5	51.0	244	289	108	27.0	4.00	7	2.20
10-H14-13	13	17.0	19.0	55	53.6	63.0	32.0	59.0	295	354	138	40.0	6.70	4	4.40
10-H14-16	16	21.5	26.0	62	62.0	75.0	38.0	66.0	348	424	170	50.0	10.00	3	7.48
10-H14-20	20	26.5	28.5	76	76.0	85.0	50.0	76.0	339	489	191	62.0	16.00	2	13.75
10-H14-22	22	33.0	33.0	97	79.0	100.0	52.0	100.0	469	566	205	65.0	19.00	1	18.81
10-H14-26	26	42.0	42.0	123	100.0	107.0	60.0	119.0	565	688	251	81.0	26.50	1	31.40
10-H14-32	32	52.0	52.0	152	135.0	152.0	75.0	153.0	680	830	329	101.0	40.00	1	65.00

IMPERIAL SPECIFICATIONS

Part Code	Chain Size inch	A inch	B inch	C inch	D inch	E inch	F inch	G inch	H inch	I inch	J inch	K inch	WLL lbs	Box Quantity	Mass lbs
10-H14-08	5/16	0.51	0.59	1.61	1.38	1.49	0.85	1.57	7.99	9.60	3.54	1.02	5700	12	2.66
10-H14-10	3/8	0.61	0.69	1.89	1.77	1.89	1.00	2.00	9.60	11.38	4.25	1.06	8800	7	4.85
10-H14-13	1/2	0.67	0.75	2.16	2.11	2.48	1.26	2.32	11.61	13.94	5.43	1.57	15000	4	9.70
10-H14-16	5/8	0.85	1.02	2.44	2.44	2.95	1.49	2.60	13.70	16.99	6.69	1.97	22600	3	16.49
10-H14-20	3/4	1.04	1.12	2.99	2.99	3.35	1.97	2.99	15.71	19.25	7.52	2.44	35300	2	30.31
10-H14-22	7/8	1.30	1.30	3.82	3.11	3.94	2.05	3.94	18.46	22.28	8.07	2.56	42700	1	41.47
10-H14-26	1	1.65	1.65	4.84	3.94	4.21	2.36	4.69	22.24	27.08	9.88	3.18	59800	1	69.23
10-H14-32	1-1/4	2.05	2.05	5.98	5.31	5.98	2.95	6.02	26.77	32.68	12.95	3.97	90400	1	143.30

Hack10 Eye Self Locking Hook

All William Hackett Hack10 lifting components comply fully with the relevant section of EN1677, ASTM A952/A and DIN PAS 1061. The grade 10 components are forged from alloy steel, they are crack detected following heat treatment and finally proof tested to 2.5 times working load. The full compliance of these components means that they can be used in chain slings certified to EN 818-4, for use in a temperature range of -40°C up to 200°C without reduction in working load limit.

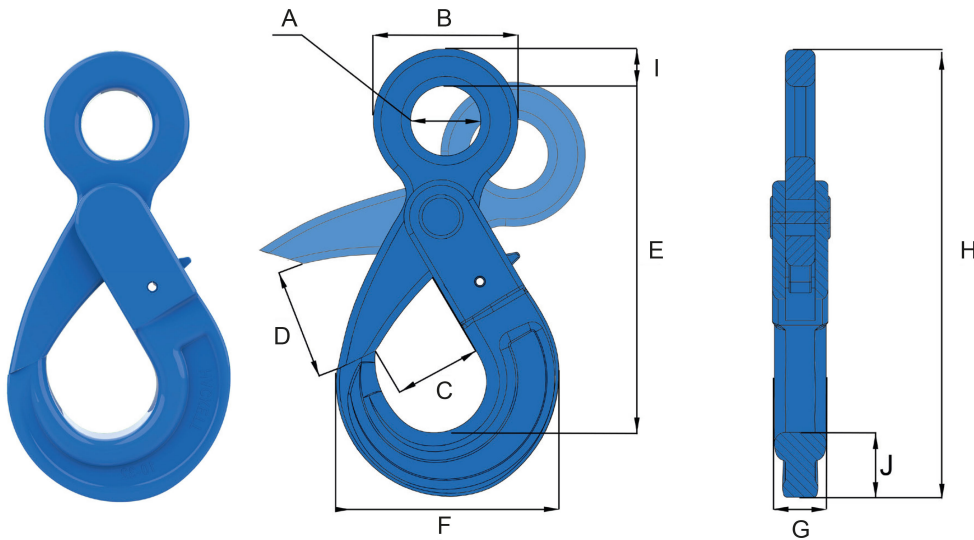

METRIC SPECIFICATIONS

Part Code	Chain Size mm	A mm	B mm	C mm	D mm	E mm	F mm	G mm	H mm	I mm	J mm	WLL tonnes	Box Quantity	Mass kg
10-H13-06	6	21.0	43.0	28.0	31.5	110.0	73.0	15.0	141.0	11.0	20.0	1.4		0.50
10-H13-08	8	27.0	51.0	36.0	40.0	137.0	90.0	20.0	175.0	12.0	26.0	2.5	12	0.90
10-H13-10	10	34.5	64.5	45.0	46.0	170.0	108.0	26.0	212.0	15.0	27.0	4.0	8	1.50
10-H13-13	13	40.0	80.0	53.6	66.0	209.0	137.5	32.5	269.0	20.0	40.0	6.7	6	2.70
10-H13-16	16	50.0	104.0	61.0	75.0	256.0	170.5	38.0	333.0	27.0	50.0	10.0	3	5.70
10-H13-20	20	60.0	124.0	76.5	80.0	277.0	191.5	50.0	368.5	30.0	62.0	16.0	2	7.90
10-H13-22	22	70.0	139.0	76.0	100.0	319.0	205.0	52.0	417.0	33.0	65.0	19.0	2	11.20
10-H13-26	26	76.0	154.0	99.0	107.0	370.0	251.0	60.0	489.0	38.0	79.0	26.5	1	20.50
10-H13-32	32	95.0	195.0	138.0	142.0	469.0	329.0	75.0	620.0	50.0	100.0	40.0	1	40.35

IMPERIAL SPECIFICATIONS

Part Code	Chain Size inch	A inch	B inch	C inch	D inch	E inch	F inch	G inch	H inch	I inch	J inch	WLL lbs	Box Quantity	Mass lbs
10-H13-06	7/32	0.83	1.69	1.10	1.24	4.33	2.87	0.59	5.55	0.43	0.79	3086		1.10
10-H13-08	5/16	1.06	2.01	1.42	1.57	5.39	3.54	0.79	6.89	0.47	1.02	5511	12	1.98
10-H13-10	3/8	1.36	2.54	1.77	1.81	6.69	4.25	1.02	8.35	0.59	1.06	8818	8	3.31
10-H13-13	1/2	1.57	3.15	2.11	2.60	8.23	5.41	1.28	10.59	0.79	1.57	14771	6	5.95
10-H13-16	5/8	1.97	4.09	2.40	2.95	10.08	6.71	1.50	13.11	1.06	1.97	22046	3	12.57
10-H13-20	3/4	2.36	4.88	3.01	3.15	10.91	7.54	1.97	14.51	1.18	2.44	35274	2	17.42
10-H13-22	7/8	2.76	5.47	2.99	3.94	12.56	8.07	2.05	16.42	1.30	2.56	41887	2	24.69
10-H13-26	1	2.99	6.06	3.90	4.21	14.56	9.88	2.36	19.25	1.50	3.11	58422	1	45.19
10-H13-32	1-17/64	3.74	7.68	5.43	5.59	18.46	12.95	2.95	24.40	1.97	3.94	88184	1	88.95

Hack10 Eye Sling Hook

All William Hackett Hack10 lifting components comply fully with the relevant section of EN1677, ASTM A952/A and DIN PAS 1061. The grade 10 components are forged from alloy steel, they are crack detected following heat treatment and finally proof tested to 2.5 times working load. The full compliance of these components means that they can be used in chain slings certified to EN 818-4, for use in a temperature range of -40°C up to 200°C without reduction in working load limit.

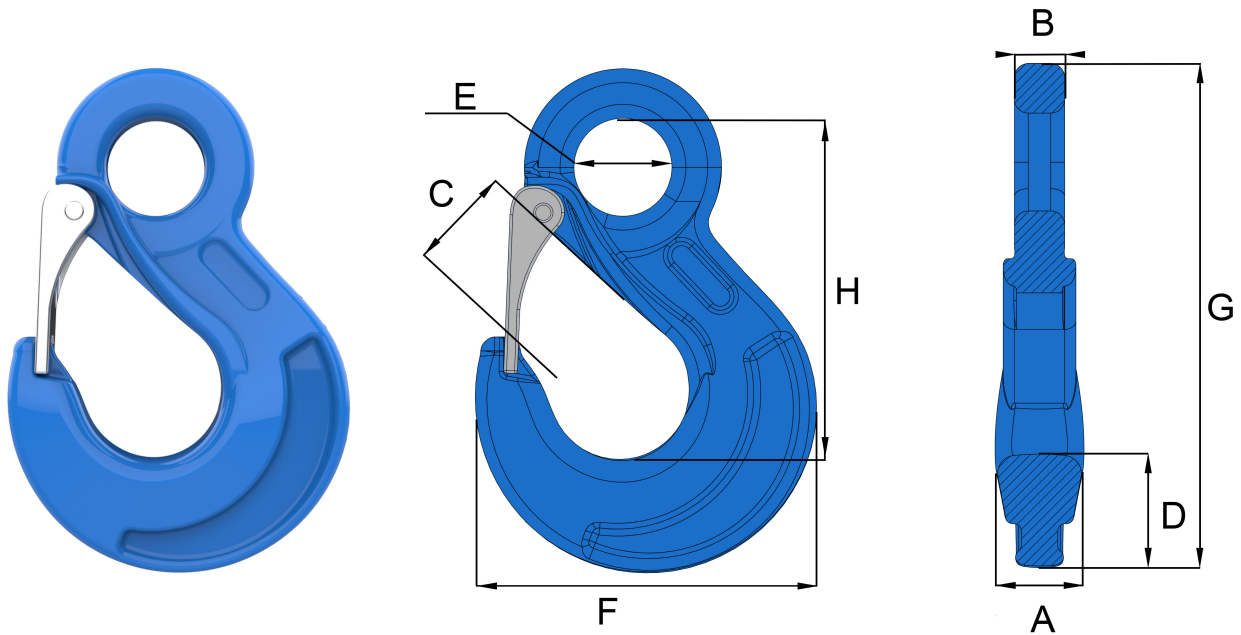

METRIC SPECIFICATIONS

Part Code	Chain Size mm	A mm	B mm	C mm	D mm	E mm	F mm	G mm	H mm	WLL tonnes	Box Quantity	Mass kg
10-H15-08	8	19.0	11.0	25.0	27.5	25.0	87.6	137.5	110.0	2.5	25	0.6
10-H15-10	10	26.0	16.0	28.0	33.0	34.0	105.0	171.5	138.5	4.0	15	1.2
10-H15-13	13	33.0	19.0	38.0	43.5	43.0	138.0	219.0	175.5	6.7	9	2.2
10-H15-16	16	40.0	24.5	46.0	50.0	50.0	162.0	260.0	210.0	10.0	6	3.5
10-H15-20	20	48.0	27.0	52.0	56.0	55.0	190.0	298.0	242.0	16.0	2	6.2
10-H15-22	22	50.0	29.0	66.0	62.0	60.0	214.0	330.0	268.0	19.0	2	11.5
10-H15-26	26	60.0	35.0	73.0	75.0	70.0	245.0	376.0	301.0	26.5	2	13.6
10-H15-32	32	71.0	39.0	87.0	89.0	81.5	270.0	458.0	369.0	40.0	2	17.5

IMPERIAL SPECIFICATIONS

Part Code	Chain Size inch	A inch	B inch	C inch	D inch	E inch	F inch	G inch	H inch	WLL lbs	Box Quantity	Mass lbs
10-H15-08	5/16	0.75	0.43	0.98	1.08	0.98	3.45	5.41	4.33	5511	25	1.32
10-H15-10	3/8	1.02	0.63	1.10	1.30	1.34	4.13	6.75	5.45	8818	15	2.65
10-H15-13	1/2	1.30	0.75	1.50	1.71	1.69	5.43	8.62	6.91	14771	9	4.85
10-H15-16	5/8	1.57	0.96	1.81	1.97	1.97	6.38	10.24	8.27	22046	6	7.72
10-H15-20	3/4	1.89	1.06	2.05	2.20	2.17	7.48	11.73	9.53	35274	2	13.67
10-H15-22	7/8	1.97	1.14	2.60	2.44	2.36	8.43	12.99	10.55	41887	2	25.35
10-H15-26	1	2.36	1.38	2.87	2.95	2.75	9.64	14.80	11.85	58422	2	29.98
10-H15-32	1-17/64	2.80	1.53	3.43	3.50	3.21	10.63	18.03	14.53	88184	2	38.58